

THE GRANARY SITE PLAN

Please note: restricted areas, designated smoking area, fire exits and fire assembly point, bins & permitted rubbish for each bin

<<< To town centre <<< --- MAYOR'S WALK --- >>> Friar's Meadow/Old Railway track >>>

River Stour - Gasworks Cut

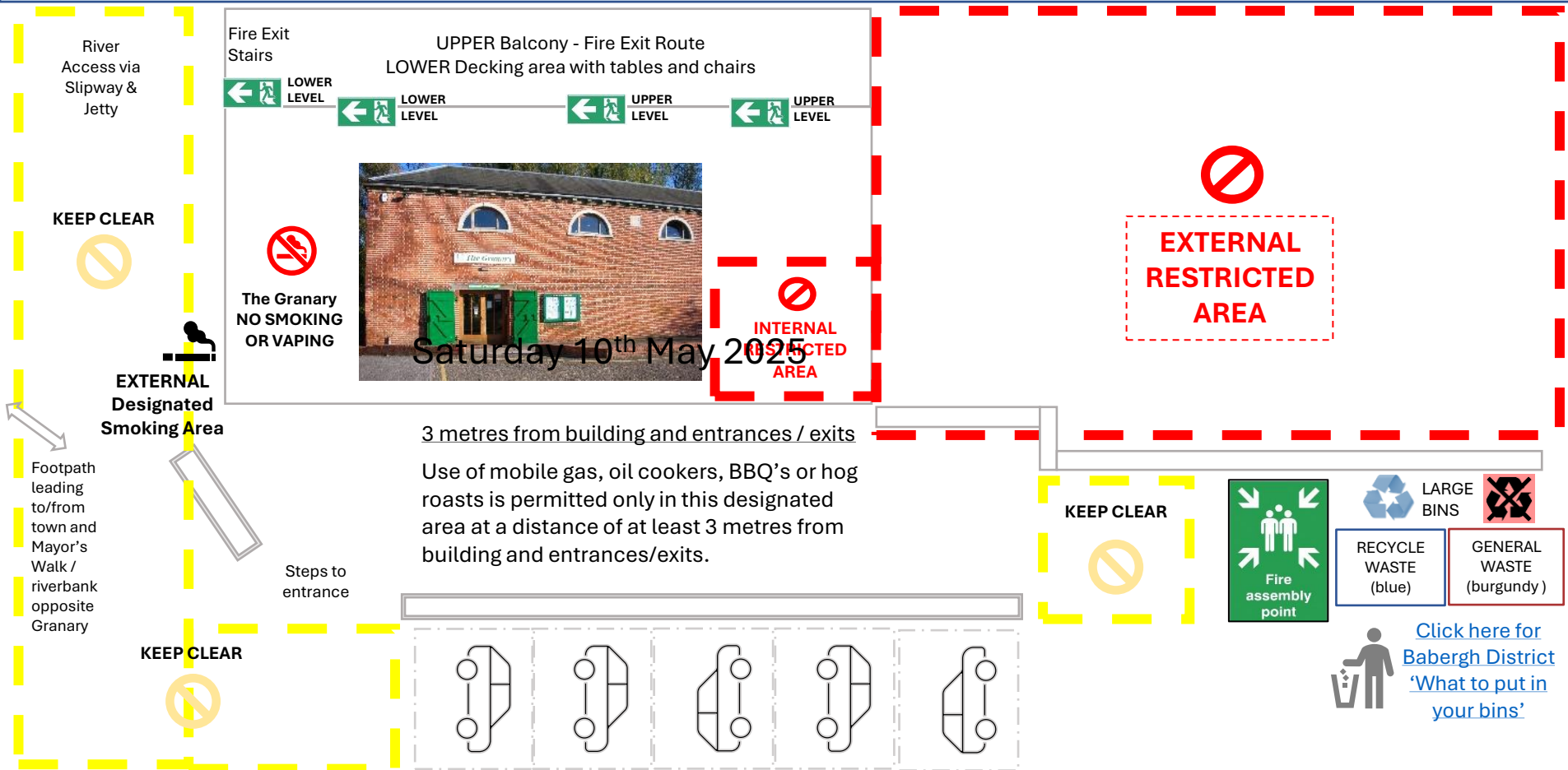

Saturday 10th May 2025

3 metres from building and entrances / exits
Use of mobile gas, oil cookers, BBQ's or hog roasts is permitted only in this designated area at a distance of at least 3 metres from building and entrances/exits.

Quay Lane Car Park (54 spaces total)

Free parking available to users of The Granary but spaces cannot be guaranteed.

Additional spaces in Babergh car park past The Quay Theatre or in town only a short walk away (one of the nearest car parks is Station Road Car Park – [click here](#) for link to Babergh District car parks and look for Sudbury.

[Click here for Babergh District 'What to put in your bins'](#)

The Barratt Room at The Granary, Quay Lane

View online images gallery of Granary layouts- [click here](#)

Table Measurements:
 Round: 116cm diameter
 Trestle: 183cm x 77cm

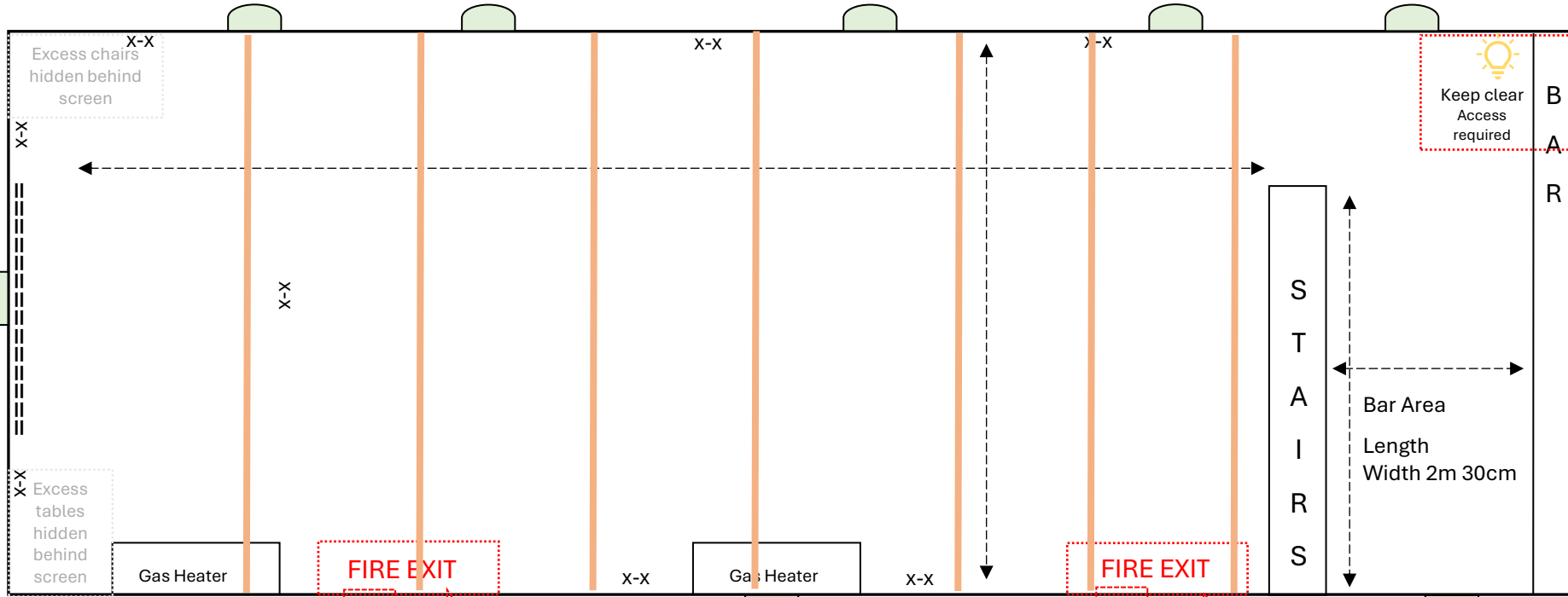
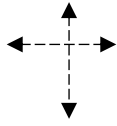

Keep fire exits clear - a gap of at least 1.2 metres leading to a fire exit is required.

KEY

- Window
- Window covered
- X** Plug Socket
- Lighting controls
- Projection Screen

Main Function Room Area = 70 sq. m (Approx: 14m x 5m)

Length 14 m Width 5 m 36 cm

Beams: Approx. 15cm (width) x 23cm (height)

Distance between each beam = approx. 220cm

Distance from floor to beam = approx. = 9 feet / 2.7m

Unused tables/chairs - round tables and chairs are accessible at far end of room. Trestle tables are accessible in downstairs foyer.

Downstairs – Entrance & Foyer

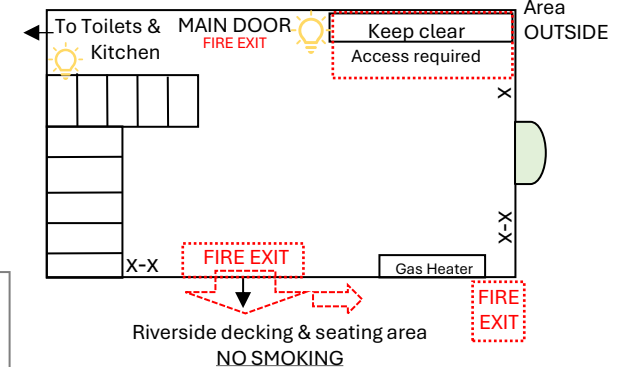

The Granary - Layout Guidance

- These diagrams are intended as a guide indicating scale and possible layout schemes upstairs (also a reminder of the entrance foyer area).
- Tables and seating layouts need to take into account where fire exits are located to ensure that we abide by health and safety regulations.
- Maximum Capacity: 100 (mixed occupancy), 70 (seated) or 80 (non-table layouts e.g. wedding ceremonies).

Table Measurements: Round: 116cm diameter / Trestle: 183cm x 77cm

- Seating up to 8 for informal meals (with minimal items for table setting)
- Seating up to 6 for formal meals (more items for the table setting)

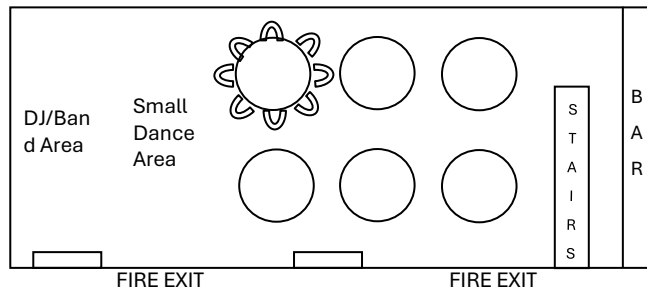
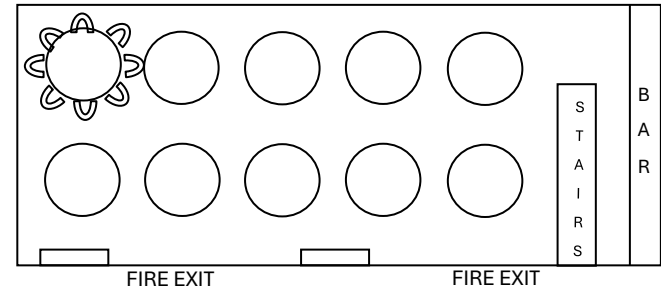
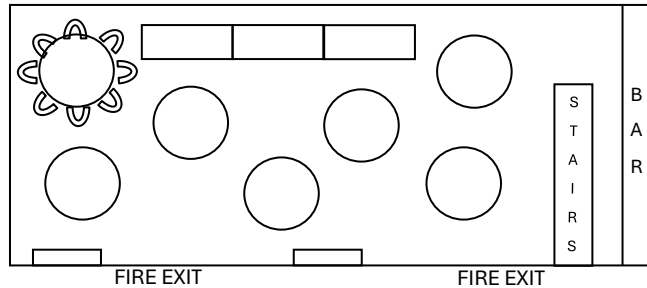
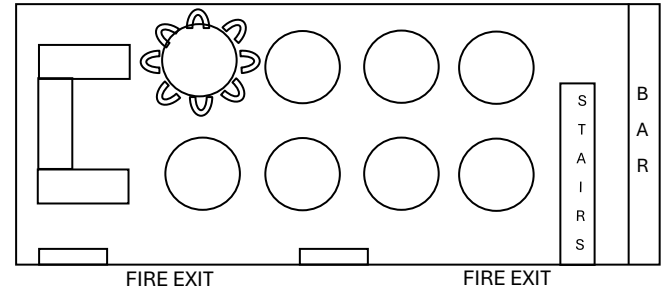
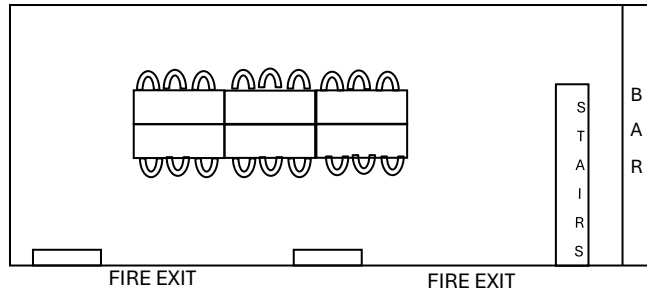

Downstairs – Entrance & Foyer

